

High-efficiency photovoltaic module using silicon nitride multicrystalline silicon cells.

Performance

Rated power (P_{max})	175W
Power tolerance	$\pm 5\%$
Nominal voltage	24V
Limited Warranty ₁	25 years

Configuration

BP 175I	Bronze frame with output cables and polarized Multicontact (MC) connectors
---------	--

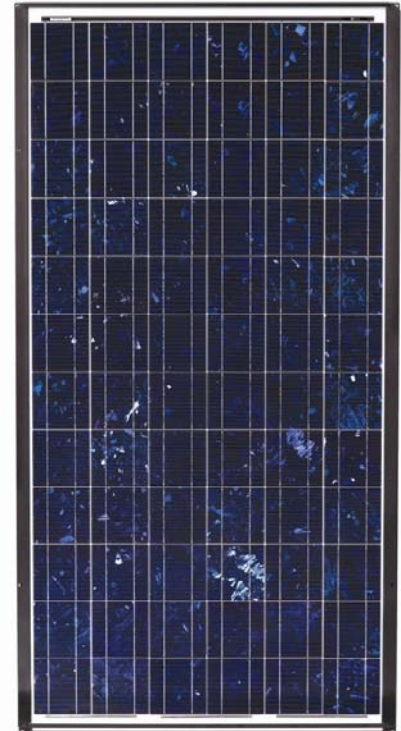

Electrical Characteristics²

	BP175I
Maximum power (P_{max}) ³	175W
Voltage at Pmax (V_{mp})	35.8V
Current at Pmax (I_{mp})	4.9A
Warranted minimum P_{max}	166.3W
Short-circuit current (I_{sc})	5.4A
Open-circuit voltage (V_{oc})	43.6V
Temperature coefficient of I_{sc}	(0.065 \pm 0.015)%/ °C
Temperature coefficient of V_{oc}	-(160 \pm 20)mV/°C
Temperature coefficient of power	-(0.5 \pm 0.05)%/ °C
NOCT (Air 20°C; Sun 0.8kW/m ² ; wind 1m/s)	47 \pm 2°C
Maximum series fuse rating	15A
Maximum system voltage	600V (U.S. NEC & IEC 61215 rating)

Mechanical Characteristics

Dimensions Length: 1587mm (62.5") Width: 828mm (32.6") Depth: 50mm (1.97")

Weight 15.4 kg (33.9 pounds)

Solar Cells 72 cells (125mm x 125mm) in a 6x12 matrix connected in series

Output Cables RHW AWG# 12 (4mm²) cable with polarized weatherproof DC rated Multicontact connectors

Diodes **IntegraBus™** technology includes Schottky by-pass diodes integrated into the printed circuit board bus

Construction Front: High-transmission anti-reflective 3mm (1/8th inch) tempered glass; White back Encapsulant: EVA

Frame Bronze anodized aluminum alloy type 6063T6 **IntegraBus™** frame; Color: Bronze

1. Warranty: Power output for 25 years. Freedom from defects in materials and workmanship for 5 years. See our website or your local representative for full terms of these warranties.
2. These data represent the performance of typical BP modules, and are based on measurements made in accordance with ASTM E1036 corrected to SRC (STC.)
3. During the stabilization process that occurs during the first few months of deployment, module power may decrease by approx. 1% from typical P_{max} .

Quality and Safety

ESTI

Module power measurements calibrated to World Radiometric Reference through ESTI (European Solar Test Installation at Ispra, Italy); Certified to IEC 61215



Listed by Underwriter's Laboratories for electrical and fire safety (Class C fire rating)

Qualification Test Parameters

Temperature cycling range	-40°C to +85°C (-40°F to 185°F)
Humidity freeze, damp heat	85% RH
Static load front and back (e.g. wind)	45psf (2160 pascals)
Hailstone impact	25mm (1 inch) at 23 m/s (52mph)

BP 175I I-V Curves

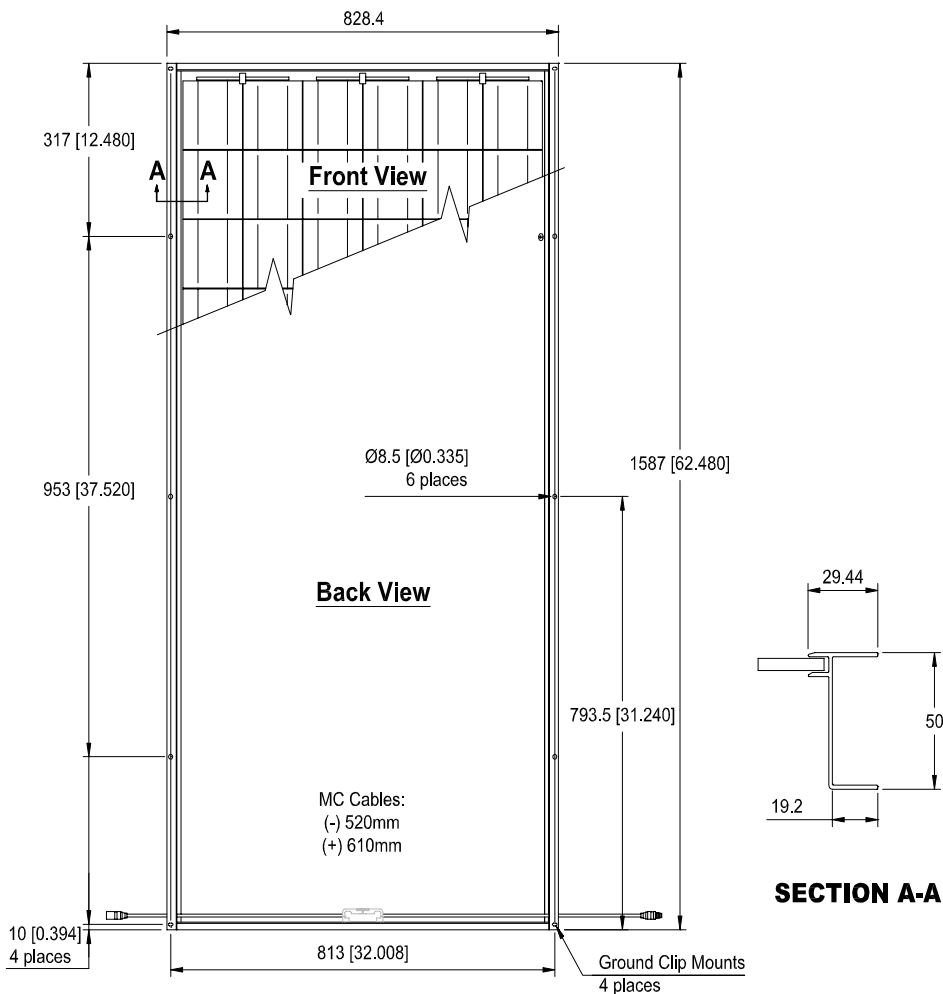
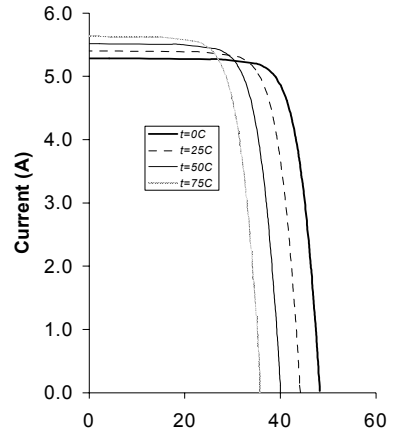

Instruction sheet, and warranty document included with each module. Mounting, grounding, wiring, and row closer kits sold separately.

Note: This publication summarizes product warranty and specifications, which are subject to change without notice. Additional information may be found on our web site: www.bpsolar.com